

110



Albert Street, Windsor
£675,000

OSBORNE HEATH



This well presented four bedroom home is in a desirable position on a communal green, within easy walking distance of both the River Thames and Windsor town centre.

The ground floor boasts a large living room overlooking the green, accessed via the entrance hall that also leads to downstairs WC, utility room and kitchen/dining room and patio doors leading out to the landscaped back garden, through which there is rear access to the property.

Upstairs the first floor has three bedrooms and a family bathroom, and the loft has been converted to create a large fourth bedroom, currently used as a study, crafting and music room.

The back garden benefits from sun throughout the day and has been landscaped to create a patio and separate lawned area with multiple sheds, including 'beach huts on a shingle beach'. The front garden faces onto the communal green.

Albert Street is a quiet residential road within easy walking distance of the River Thames and Windsor town centre, and has resident permit parking, with electric car charging facilities. Windsor has a wide range of shops and restaurants as well as the Castle, Great Park, Racecourse and Legoland. Nearby train stations include Windsor & Eton Central and Windsor & Eton Riverside where trains run to London Paddington and on the Elizabeth Line through central London (via Slough) and London Waterloo. Windsor is also convenient for the M4, M25, M40, M3 and Heathrow Airport.

Albert Street

Windsor

- Four Bedrooms
- Utility Room
- Downstairs WC
- Bright Landscaped Garden
- Overlooking Communal Green
- Quiet Road
- Cul-De-Sac
- Close To Town Centre
- Close To River

Council Tax band: D

Tenure: Freehold

EPC Energy Efficiency Rating: C

EPC Environmental Impact Rating: C



APPROXIMATE FLOOR AREA
House - 127.00 sq m - 1367 sq ft
(Gross Internal Area)



NOT TO SCALE
This plan is for illustration purposes only

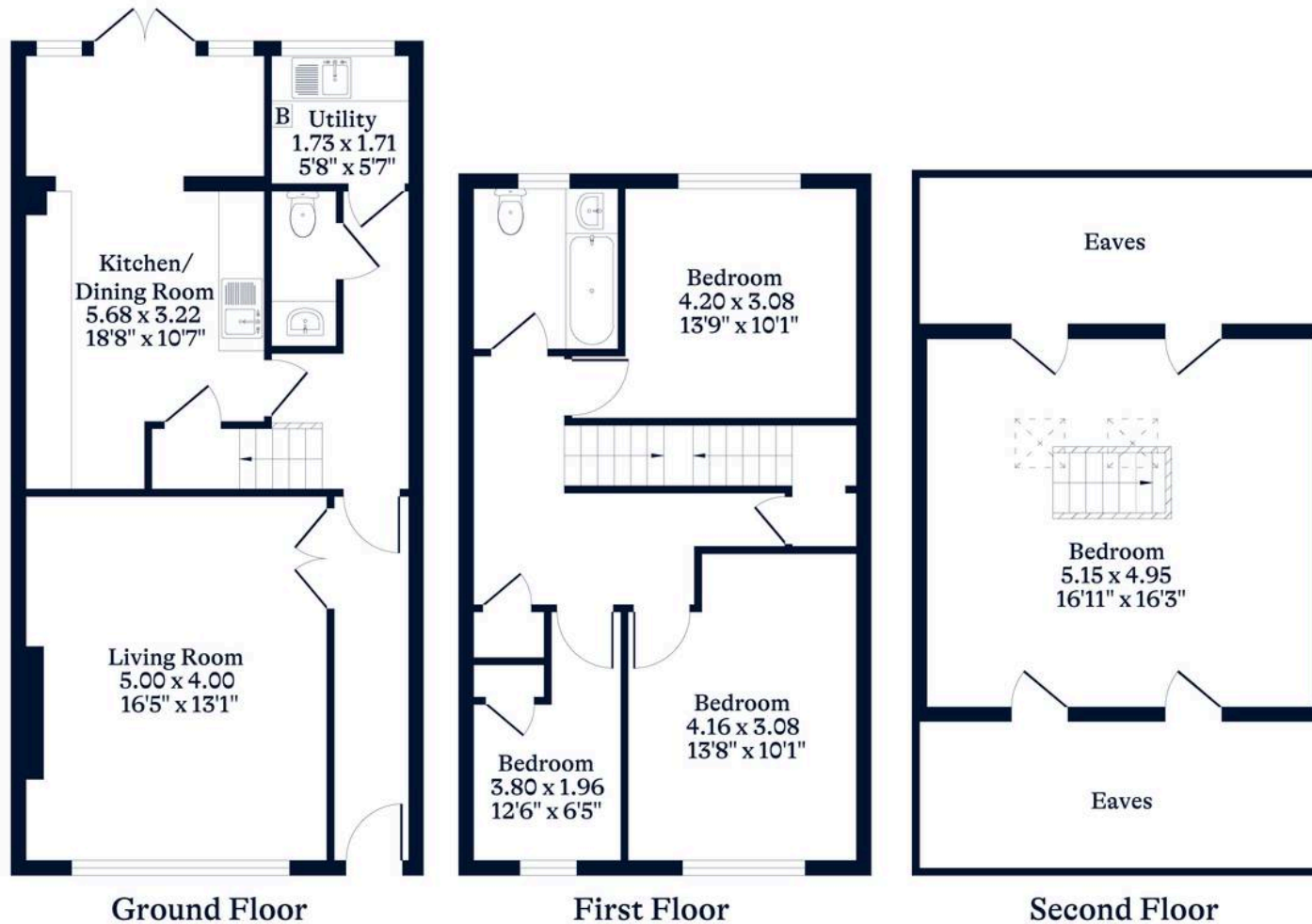

OSBORNEHEATH.CO.UK

This floor plan has been created by Property Shoot Ltd following the RICS code of measuring and is for indicative guidance only. Whilst every attempt has been made to ensure the accuracy of the floor plan contained here, measurements of doors, windows and rooms are approximate and no responsibility is taken for any error, omission or misstatement. Details shown on this floorplan, including all measurements, areas and proportions cannot be guaranteed by either the provider or estate agency and should not be relied upon.